

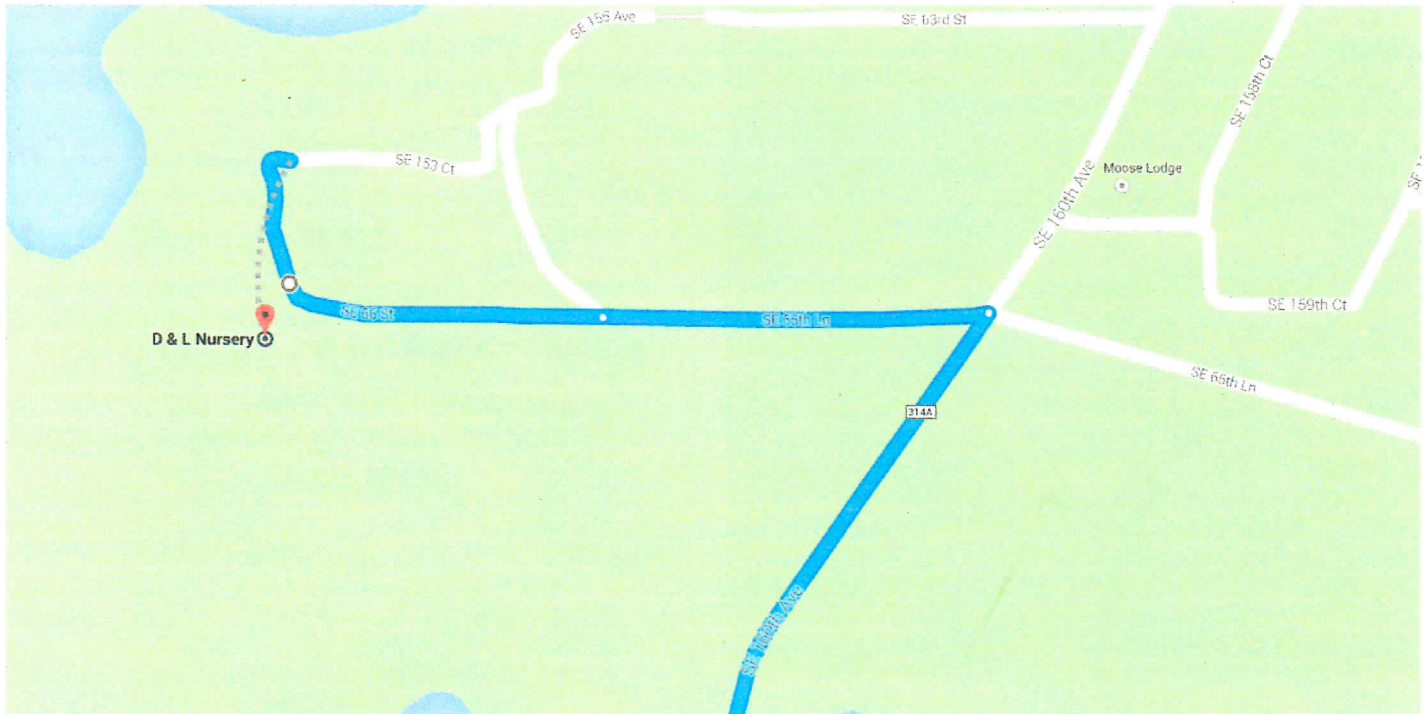

### Directions from Spanish Springs Town Square to D & L Nursery



### ○ Spanish Springs Town Square

Alonzo Avenue, Lady Lake, FL 32159

Follow Co Rd 25, County Rd 464C N and SE 160th Ave to SE 65th Ln in Marion County

16.8 mi / 23 min

- ↑ 1. Head southeast on FL-500 E/US-27 S/US-441 S toward Plaza Blvd 0.1 mi
- ↶ 2. Turn left onto Griffin Ave 0.9 mi
- ↶ 3. Turn left onto Co Rd 25 8.4 mi
- ↷ 4. Turn right onto SE 135 Ave 0.3 mi
- ↑ 5. Continue onto County Rd 464C N/SE 135th Ave/Oklawaha Ave 4.2 mi

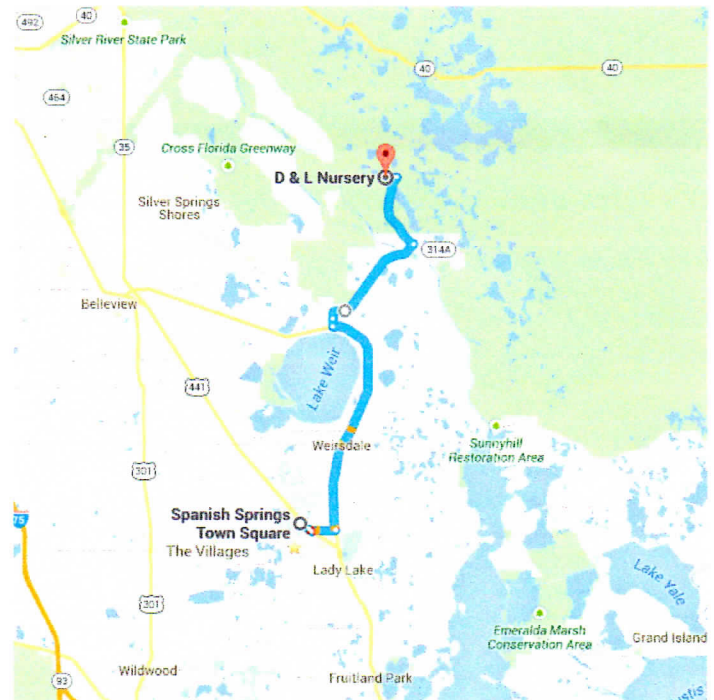

↩ 6. Turn left onto SE 160th Ave

2.8 mi

Drive to SE 66 St

0.5 mi / 2 min

↩ 7. Turn left onto SE 65th Ln

0.2 mi

↑ 8. Continue onto SE 66 St

0.3 mi

If you see the MOOSE Lodge on SE 160th Ave you have just passed the turn off to the NURSERY.

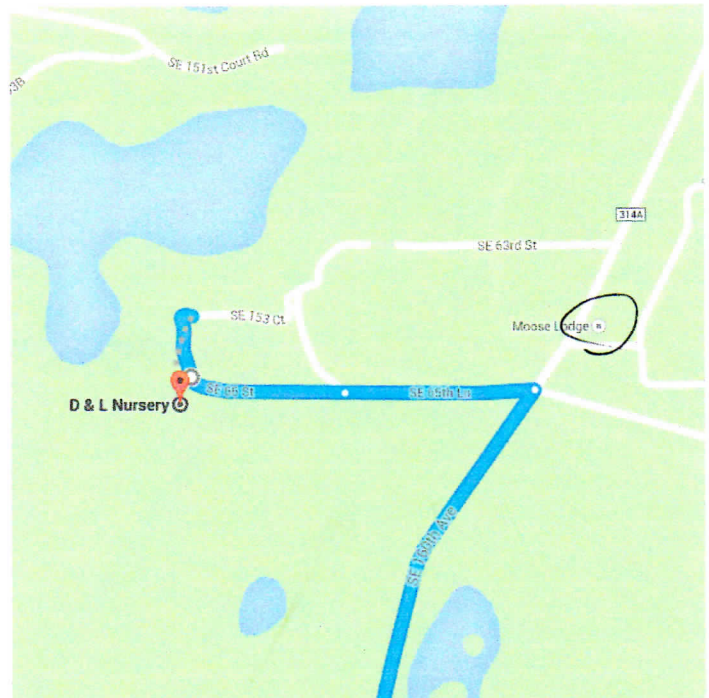

### 📍 D & L Nursery

6550 Southeast 153 Court, Ocklawaha, FL 32179

These directions are for planning purposes only. You may find that construction projects, traffic, weather, or other events may cause conditions to differ from the map results, and you should plan your route accordingly. You must obey all signs or notices regarding your route.